



## Splitter Duo DIN

Splitter Duo DIN (Splitter Duo Din) presents is a two-channel DMX512 interface splitter and is effective solution for controlling lighting equipment, using the DMX512 standard. The feature of the splitter is the ability to transfer protocols DMX512, RDM (ANSI E1.20) from 1 or 2 inputs for 8 or 9 outputs. Splitter Duo DIN has smart indication to indicate the presence signal DMX512, the presence of the fact of data transmission over the DMX512 line, and the presence of RDM interface signals (ANSI E1.20). The splitter provides manual switching of operating modes (one or two ports). The device is designed in a housing for DIN rail mounting and can be used with positive and subzero temperatures indoors and outdoors. The flexibility in device placement is characterized by its compactness, the ability to be installed in a cabinet on a DIN rail and is 12 modules in size.



### Benefits

- Permanently laser-etched aluminum housing
- Maintaining performance at voltages up to 305 V
- Supports DMX512, RDM (ANSI E1.20) protocols
- Intelligent indication of operating modes
- Galvanic isolation of DMX ports
- Free cooling function without the use fans and holes in the case

### Application area

- For use in outdoor installations with control cabinets where branching is required multiple lines of the DMX512 protocol, RDM (ANSI E1.20)

# Splitter Duo DIN

Version: 5.00  
21.04.22

## Technical specifications

### Mechanical

Enclosure: DIN rail (12 modules)  
Material: metal, plastic  
Dimensions, mm: 210 (L) x 105 (H) x 75 (W)  
Weight: 0.85 kg  
Installation: power supply cabinet

### Power & Electrical

Power supply: ~ 100-250 V, 50/60 Hz  
Max power consumption: 5W  
Fuse: 0.5 A

### Environmental

Operating temperatures: -40 ... + 70 ° C  
Storage temperatures: -50 ... + 80 ° C  
Max. relative humidity: 95%  
IP Rating: IP 23  
Certificates: EAC, CE, RoHS  
Warranty: 36 months

### Control / Data Connections

Supported protocols: DMX512, RDM  
Refresh rate DMX data: 44 Hz

### Inputs / Outputs

DMX inputs: 1 or 2  
DMX Outputs: 8 or 9  
DMX connectors: terminal blocks 15EDGVC-3.5-03

### Configuration / Indication

Indicators: LED, for DMX inputs

### Package Contents

Splitter Duo DIN  
Connector set

---

## Product Line

### Modification

Splitter Duo DIN

### Vendor Code

SPDD-1-2D8D

# Splitter Duo DIN

Version: 5.00  
21.04.22

## Connection diagram

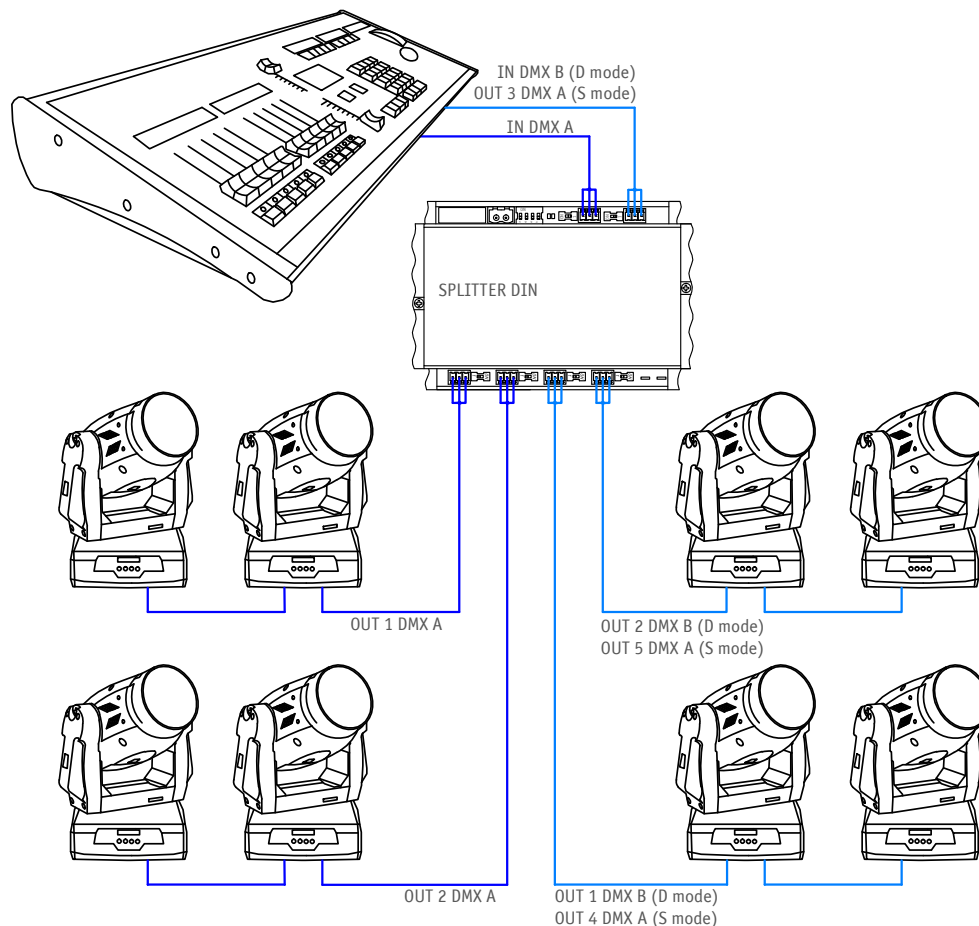

### DIP switch

	ON	OFF
SW1	RDM enabled	RDM disabled
SW2	Dual splitter mode (D-mode)	Single Splitter Mode (S-mode)
SW3	Transparent mode	Dedicated input mode
SW4	Display mode Bus	DMX512 indication mode

### LED indication

	DMX512 mode	Bus Mode
Green	Valid DMX signal	The bus is free
Red	No DMX signal	Bus busy
Amber	Device / section does not work	Device / section does not work



Specifications and appearance of Sandrax Electronics brand equipment are subject to change without notice.

### Accessories

#### Name

Ethernet cable, RJ45, 3m  
Set for mounting DIN enclosures (DIN rail) length 0.3 m

#### Vendor Code

ACC-CCE-X/RJ3  
ACC-MK-DIN03