

# BTI-TRUSSLITE

## DESCRIPTION

Weatherproof compact IP65 projector, equipped with 3x 10W RGBL LEDs and wireless DMX. Fits into any ALU truss to illuminate it colourfully from the inside.

## FEATURES

- This powerful outdoor IP65-projector is an always perfect fit when illuminating various trusses!
- Thanks to its small size, it can be inserted in almost any truss.
- Based on 3 pcs 10watt RGBL LEDs - beam 10° (25° frost filter included)
- **W-DMX Transceiver** for wireless master/slave & DMX control (100% compatible with **W-DMX G4 protocol**).
- Different working modes for maximum flexibility:
  - **Standalone:** custom colors, color + CCT presets or automatic color changes
  - **Master/slave mode:** the master controls the slaves wirelessly or via XLR cabling, creating wonderful light shows
  - **DMX-controlled:** wired and wireless. (4 modes: 3ch HSV, 4ch RGBL, 4ch LEDCON-02 Mk2 and 8ch STAGE for extended control)
  - **Used as wireless transceiver:** In the absence of a separate W-DMX transceiver, this projector can perfectly serve as a replacement for it!
  - **IR remote control:** simple control using a cheap (optional) remote, even in master/slave mode
- The graphic OLED display shows a lot of important information.
- Combined with the touch keys, it also provides smooth setup menu operation.
- Optional IR-4 remote control available
- Completely silent “passive” cooling (NO cooling fans!).
- Seetronic PowerCON TRUE1 compatible mains in- and output for easy daisy chaining.
- The standard weatherproof 5-pin XLR in- and output connectors can be easily converted in 3-pin XLR with the optional conversion kit “BT-XLR5TO3 KIT”.

*NOTE: this product has IP65 rating while used for non-permanent outdoor installation and under normal conditions (not exposed to seawater).*

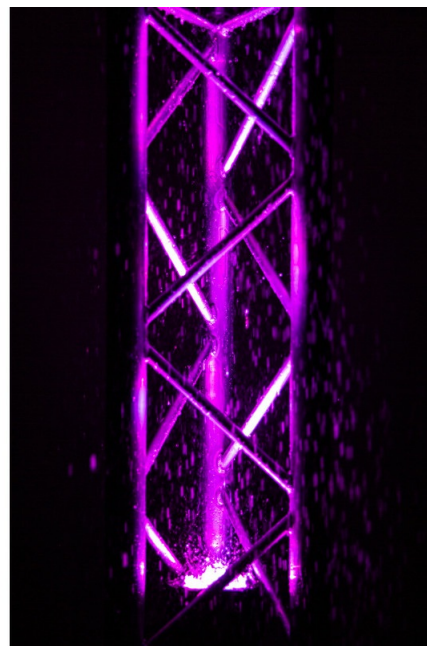

TECHNICAL SPECIFICATIONS

General : Dimensions (cm)	13.1 x 11.6 x 15.3
General : Weight (kg)	1.65
General : Powerinput	AC 100 - 240V, 50/60Hz
General : Energy Label	No
General : Power consumption W	40
General : Color	black
General : Display	OLED
General : Fixation	M10
General : IP rating	outdoor
Control : Modes	standalone fixed, standalone automatic, remote, manual, DMX, Master/Slave
Control : Protocol	DMX, Wireless DMX, RDM
Control : optional remote	IR-4
Control : programmable	No
Control : upgradable software	Yes
Control : minimum DMX channels	3
Control : maximum DMX channels	8
Light : lamp socket	No
Light : Lux	829 @5m (beam: 10°)
Light : lamp	LED
Light : min. color temperature (K)	2500
Light : max. color temperature (K)	6000
Light : colors	RGBL
Light : mix colors	Yes
Light : functions	1 frost filter included
Light : min. beam angle (°)	10
Light : max. beam angle (°)	25
Light : max. refresh rate (kHz)	7.2
Connections : input	5 pin XLR, wireless DMX, rdm, PowerCon® TRUE1 or compatible
Connections : output	5 pin XLR, wireless DMX, rdm, PowerCon® TRUE1 or compatible
Brand	BRITEQ
EANCode	5420025651899
SKU	B05189

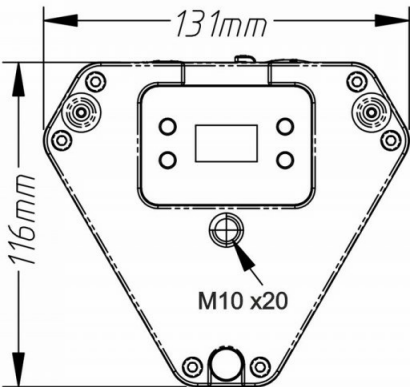
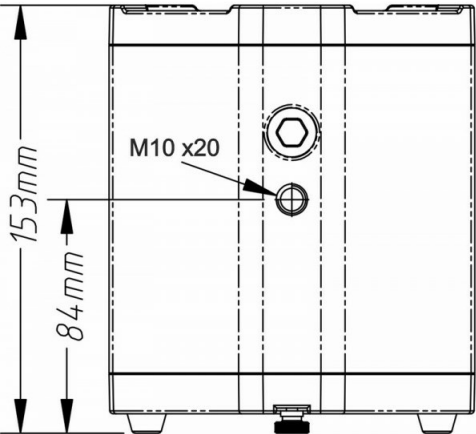
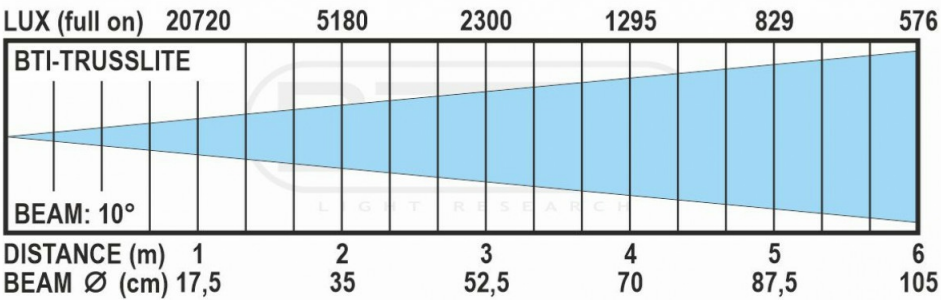

YOUR DEALER



WWW.BRITEQ-LIGHTING.COM | WWW.FACEBOOK.COM/BRITEQ

BEGLEC NV HAS THE RIGHT TO CHANGE PRODUCTS AND SPECIFICATIONS WITH AND WITHOUT NOTICE. MAJOR AS WELL AS MINOR CHANGES CAN BE INVOLVED. THIS LEAFLET CAN CONTAIN ERRORS, THEREFORE WE ADVISE TO CONSULT YOUR LOCAL DEALER TO ENSURE THAT ACTUAL FEATURES AND SPECIFICATIONS MATCH YOUR REQUIREMENTS. COPYRIGHT © 2025 BY BEGLEC NV. ALL RIGHTS RESERVED.