



■ C6001A
■ C6001B



Aluminium truss clamp

- SWL (safe working load): 500 kg
- Bolt size: M10 x 40 mm
- Fits 48 - 51 mm diameter tubes
- High tensile aluminium



■ C6002A
■ C6002B



Aluminium truss clamp, slim design

- AWL (safe working load): 200 kg
- Bolt size: M10 x 40 mm
- Fits 48 - 51 mm diameter tubes
- High tensile aluminium



■ C6003A
■ C6003B



Aluminium truss double-clamp

- SWL (safe working load): 500 kg
- Fits 48-51 mm diameter tubes
- High tensile aluminium



■ C6004A
■ C6004B



Aluminium truss clamp designed to allow one person to hang heavy luminaires, through the automatic closing of the trigger

- SWL (safe working load): 250 kg
- Bolt size: M10 x 35 mm
- Fits 48 - 51 mm diameter tubes
- High tensile aluminium



■ C6007A
■ C6007B



Aluminium truss clamp with a quick-locking system

- SWL (safe working load): 100 kg
- Bolt size: M10 x 35 mm
- Fits 48 - 51 mm diameter tubes
- High tensile aluminium



■ C6011A
■ C6011B



Light-weight aluminium truss clamp, slim design

- SWL (safe working load): 100 kg
- Bolt size: M10 x 35 mm
- Fits 48 - 51 mm diameter tubes
- High tensile aluminium



■ C6015A
■ C6015B



Light-weight aluminium truss double-clamp, slim design

- SWL (Safe working load): 100 kg
- Fits 48-51 mm diameter tubes
- High tensile aluminium



■ C6016A
■ C6016B



Aluminium truss clamp designed to allow one person to hang heavy luminaires, through the automatic closing with the weight of the object being hung

- SWL (safe working load): 250 kg
- Bolt size: M10 x 35 mm
- Fits 48 - 51 mm diameter tubes
- High tensile aluminium



■ C6017A
■ C6017B



Aluminium truss clamp with eyebolt applied

- SWL (safe working load): 200 kg
- Fits 48-51 mm diameter tubes
- High tensile aluminium



■ C6020A
■ C6020B



Aluminium truss side-clamp

- SWL (safe working load): 500 kg
- Bolt size: M10 x 40 mm
- Fits 48-51 mm diameter tubes
- High tensile aluminium



■ C6022A
■ C6022B



Aluminium truss double-clamp

- SWL (safe working load): 200 kg
- Fits 48 - 51 mm diameter tubes
- High tensile aluminium



■ C6028A
■ C6028B



Aluminium truss clamp, slim design

- AWL (safe working load): 200 kg
- Half spigot, bolt, pin
- Bolt size: M10 x 40 mm
- Fits 48 - 51 mm diameter tubes
- High tensile aluminium

48-51 mm



C6031

Superclamps are pressured die-cast aluminium clamps capable of clamping any surface from 13 mm flat to 50 mm diameter poles. Rubber grip pads prevent damage to surfaces. Supplied with a wedge to grip flat surfaces. There is a full range of snap in accessories to complement these versatile clamps.

- SWL (safe working load): 15 kg
- Flat surface grip: 13-30 mm
- Tubes grip: 15-50 mm
- Built-in pressure die-cast aluminium
- M10 x 25 rotating studs included



C6032

Clamp manufactured from die-cast aluminium for light-weight equipment (SWL 50 kg), compatible tubes of 48-51 mm. Its design has been conceived to eliminate truss damage

- SWL (safe working load): 50kg
- TUV approval
- Captive M10 bolt
- Fits 48-51 mm diameter tubes / 10-30 mm board



■ **C6033A**
■ **C6033B**

Light-weight steel truss clamp, slim design

- SWL (safe working load): 40 kg
- Bolt size: M10 x 40 mm
- Fits 35-51 mm diameter tubes



■ **C6034A**
■ **C6034B**

Clamp manufactured from die-cast aluminium for light-weight equipment (SWL 200 kg), compatible tubes of 48-51 mm. The design has been conceived to eliminate truss damage usually associated with steel hook clamps and grants a faster mounting through two turns of the knob

- SWL (safe working load): 200 kg
- TUV approval
- Bolt size: M10 x 35 mm
- Fits 48 - 51 mm diameter tubes

32-35 mm



■ **C6005A**
■ **C6005B**

Aluminium truss clamp

- SWL (safe working load): 75 kg
- Bolt size: M10 x 35 mm
- Fits 32-35 mm diameter tubes
- High tensile aluminium

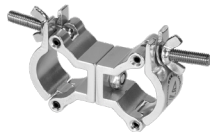

■ **C6006A**
■ **C6006B**

Aluminium truss double-clamp

- SWL (safe working load): 50 kg
- Fits 32-35 mm diameter tubes
- High tensile aluminium



■ **C6035A**
■ **C6035B**

Clamp manufactured from die-cast aluminium for light-weight equipment (SWL 75 kg), compatible tubes of 32-35 mm. The design has been conceived to eliminate truss damage usually associated with steel hook clamps and grants a faster mounting through two turns of the knob

- SWL (safe working load): 75 kg
- TUV approval
- Bolt size: M8 x 30 mm
- Fits 32-35 mm diameter tubes