



Photo: © the Prolyte. Omke Oudeman.

Couplers

When Prolyte designed the original Conical Coupling System (CCS®), it represented a huge step forward in the development of truss systems. Even today, the now much-copied Conical Coupling System is unrivalled in efficiency, strength and ease of assembly. Exhibiting significant advantages over other types of connection systems, the innovative Conical Coupling System has gained a worldwide reputation for excellence and efficiency. The Conical Coupling System is available for all Prolyte truss systems and is deliverable in 3 sizes: CCS4, CCS6 and CCS7. A variety of special coupling configurations is also available. With strong and rigid connections, the Conical Coupling System makes the assembly of your truss system safe, fast and easy.

Accessories

Prolyte accessories are a range of additional products that can be used in combination with the Prolyte trusses or other complementary products.

This section presents a selection of accessories that might prove helpful in the assembly or setting-up of your truss constructions. Prolyte accessories all have one thing in common: they have been developed to help you realize the many possibilities and full potential offered by your Prolyte truss system. All Prolyte accessories are designed and manufactured to the highest industry standards, and all comply with safety regulations and, where applicable, are TUV approved. Prolyte accessories are divided into four categories: clamps, followspot chairs, exhibition products and rigging gear.

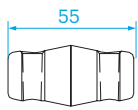

CCS4-400 weight = 0,058 kg
Conical coupler



CCS4-403 weight = 0,017 kg
Spigot
CCS4-403-RF (stainless steel) To be used with CCS6 - 605 safety R-spring

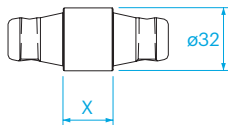

CCS4-S05 through CCS4-S50 weight = 0,070 - 0,170 kg
Spacers X = 5 mm to 50 mm in steps of 5 mm

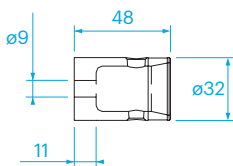

CCS4-451 weight = 0,065 kg
Female conical coupler With 9 mm hole for bolts M8

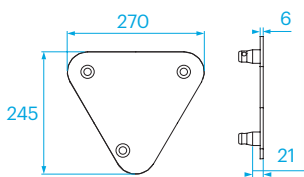

BASE 20D weight = 0,740 kg
Baseplate for E20D truss incl:
CCS4-402 Offset half conical coupler
BM-M6x020-IB-CS Bot M6x20mm countersunk

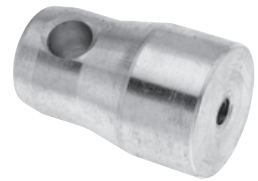
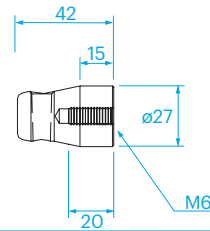

CCS4-402 weight = 0,050 kg
Offset half conical coupler Offset 15 mm, thread M6

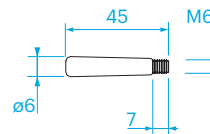

CCS4-404 weight = 0,017 kg
Spigot with tread M6
CCS4 - 404-RF (stainless steel) To be used with selflocking nut BM-M6-SN

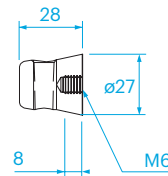

CCS4-450 weight = 0,029 kg
Half conical coupler Offset 0 mm, thread M6

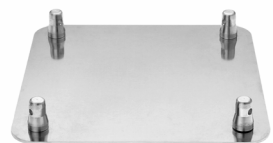
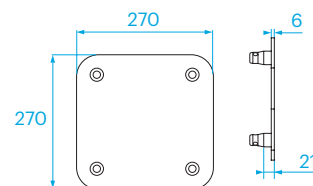

BASE 20V weight = 1,170 kg
Baseplate for E20V truss incl:
CCS4-402 Offset half conical coupler
BM-M6x020-IB-CS Bot M6x20mm countersunk

COUPLERS CCS6

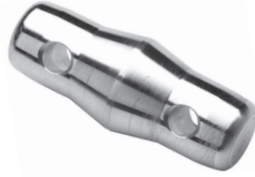
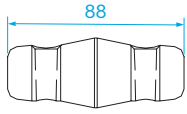

CCS6-600 weight = 0,148 kg
Conical coupler

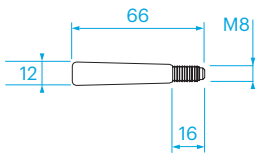

CCS6-604 weight = 0,040 kg
Spigot with thread M8
CCS6 - 604RF (stainless steel) To be used with selflocking nut
BM-M8-SN

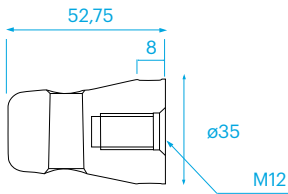

CCS6-649 weight = 0,09 kg
Half conical coupler baseplate Offset 8 mm, thread M12

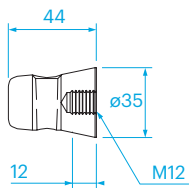

CCS6-650 weight = 0,069 kg
Half conical coupler Offset 0 mm, thread M12

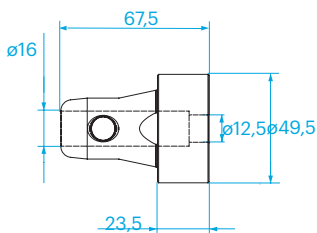

CCS6-652-23,5 weight = 0,469 kg
Half conical coupler Offset 23,5 mm, 12,5 mm hole
To be used with a M12 Hexagon head

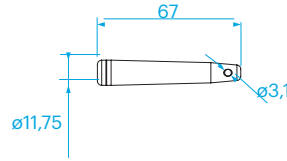

CCS6-603 weight = 0,042 kg
Spigot
CCS6-603RF (stainless steel) To be used with CCS6-605 safety
R-spring

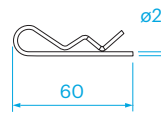

CCS6-605 weight = 0,003 kg
Safety R-spring

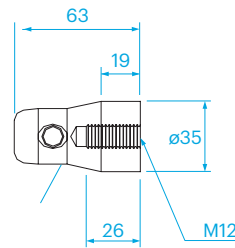

CCS6-602 weight = 0,116 kg
Offset half conical coupler Offset 19 mm, thread M12

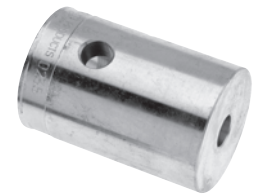
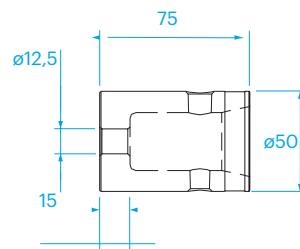

CCS6-651 weight = 0,280 kg
Female conical coupler With 12,5 mm hole for bolts M12

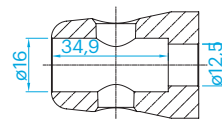

CCS6-652S
Male coupler 600 half With 12,5 mm hole for bolts M12
BM - M12 x 028 - 652. Bolt M12 x 028 bolt for CCS6 - 652S

COUPLERS CCS6

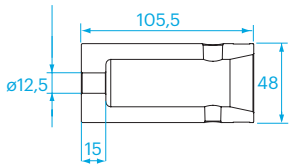

CCS6-653	weight = 0,360 kg
Female conical coupler	With 12,5 mm hole for bolts M12

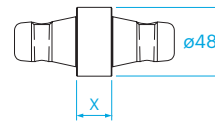

CCS6-S02 through CCS6-S50	weight = 0,187 kg - 0,404 kg
Spacers	X = 2 mm to 50 mm in steps of 5 mm

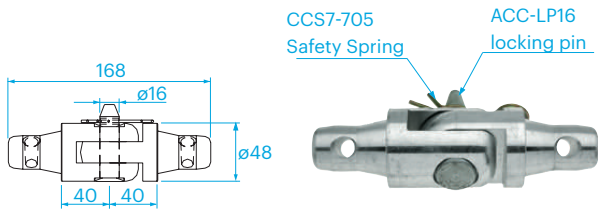

CCS6-H	weight = 0,590 kg
Hinge for MPT Tower or ST Tower, 4 hinges per tower needed. See BlackBook "Technical Matters" for the use of hinges in different setups.	

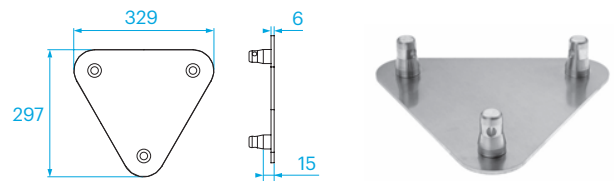

BASE 30D	weight = 1,160 kg
Baseplate for X+H30D truss incl:	
CCS6-649	Conical half coupler
BM-M12X020-IB-CS	Bot M12X20mm countersunk

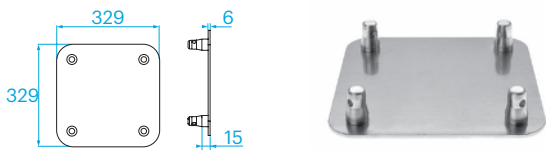

BASE 30V	weight = 1,860 kg
Baseplate for X+H30D truss incl:	
CCS6-649	Conical half coupler
BM-M12X020-IB-CS	Bot M12X20mm countersunk

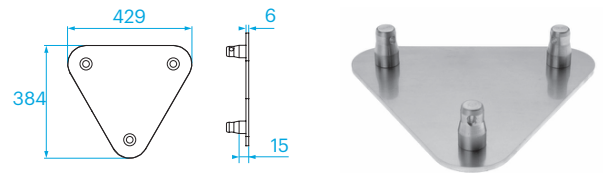

BASE 40D	weight = 2,700 kg
Baseplate for H40D truss incl:	
CCS6-649	Conical half coupler
BM-M12X020-IB-CS	Bot M12X20mm countersunk

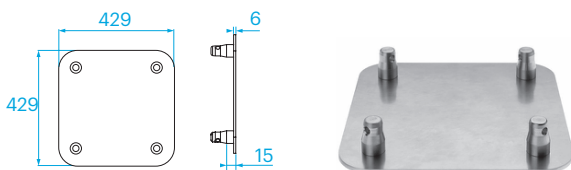

BASE 40V	weight = 2,820 kg
Baseplate for H40D truss incl:	
CCS6-649	Conical half coupler
BM-M12X020-IB-CS	Bot M12X20mm countersunk

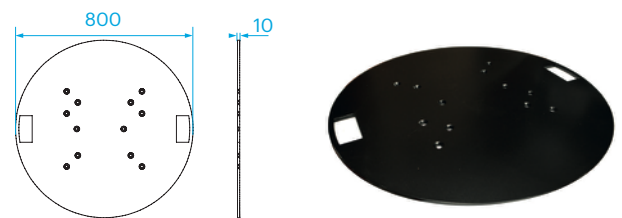

BASE-30-40-RS-BC	weight = 38 kg
Base steel 30-40 series 800x10 mm round black coated;	
BASE-30-40-RS-G	- Galvanized
CCS6-649	Conical half coupler
BM-M12X020-IB-CS	Bot M12X20mm countersunk

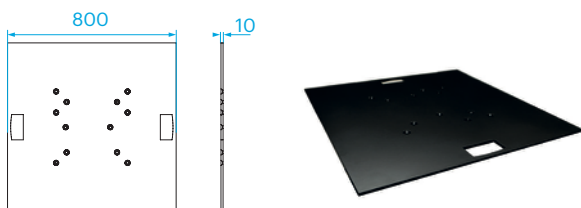

BASE-30-40-SS-BC	weight = 49 kg
Base steel 30-40 series 800x10 mm round black coated;	
BASE-30-40-SS-G	- Galvanized
CCS6-649	Conical half coupler
BM-M12X020-IB-CS	Bot M12X20mm countersunk

COUPLERS CCS7

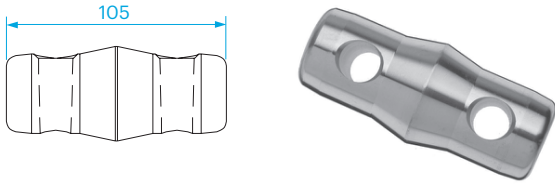

CCS7-700 weight = 0,310 kg
Conical coupler

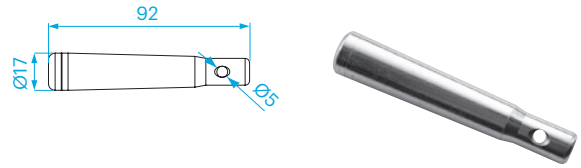

CCS7-703 weight = 0,115 kg
Spigot
To be used with CCS7 - 705

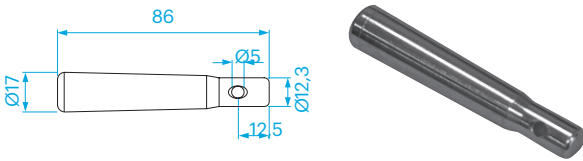

CCS7-703-C52T weight = 0,110 kg
Spigot (Flush with truss)
To be used with CT Towers.

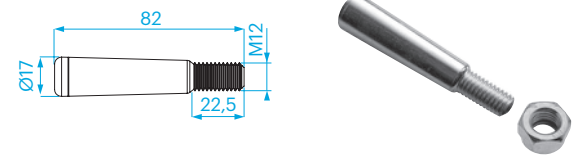

CCS7-704 weight = 0,125 kg
Spigot with thread M12
CCS7 - 704RF (stainless steel)
To be used with selflocking nut BM-M12-SN

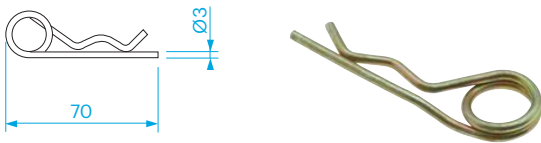

CCS7-705 weight = 0,012 kg
Safety R-spring

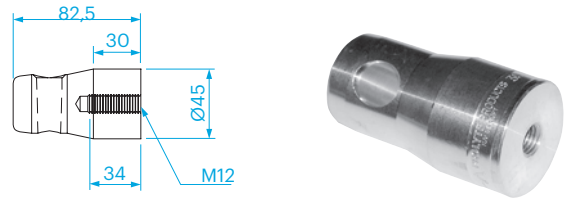

CCS7-702/12 weight = 0,265 kg
Offset half conical coupler
Offset 31 mm, thread M12

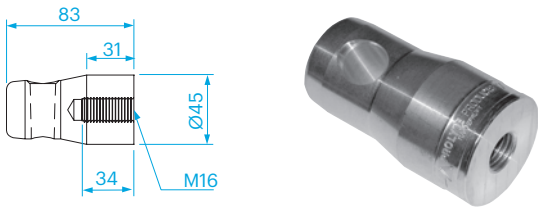

CCS7-702/16 weight = 0,260 kg
Offset half conical coupler
Offset 31 mm, thread M16

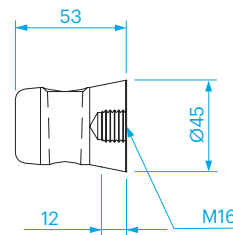

CCS7-750 weight = 0,150 kg
Half conical coupler
Offset 0 mm, thread M16

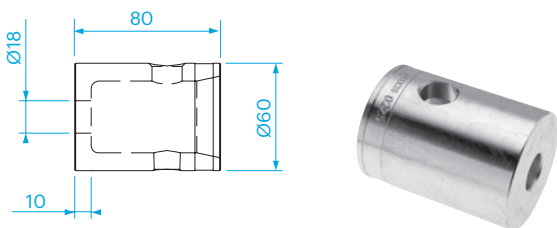

CCS7-751 weight = 0,350 kg
Female conical coupler
With 18 mm hole for bolts M16

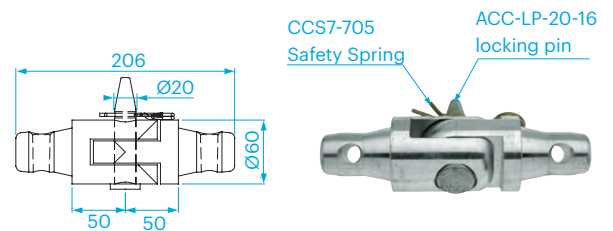

CCS7-H-O / CCS7-H-90 weight = 1,240 kg
Hinge for 36V and 52V truss. See BlackBook "Technical Matters" for the use of hinges in different setups.

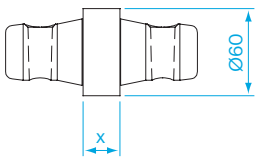

CCS7-S10 through CCS7-S50 weight = 0,350 kg - 0,360 kg

Spacers x = 2 mm to 50 mm, in steps of 5 mm (minimum of 2 mm)

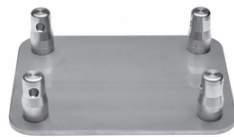
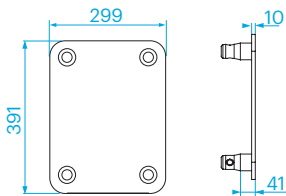

BASE 36R weight = 1,860 kg

Baseplate for 36R truss incl:
CCS7-702/16 Conical half coupler
BM-M16X040-IB-CS bolt

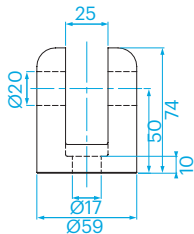

CCS7-H-FM-BOLT weight = 0,326 kg

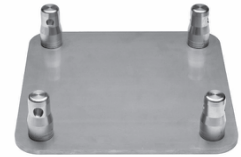
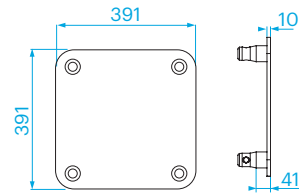

BASE 36V weight = 1,160 kg

Baseplate for 36V truss incl:
CCS7-702/16 Conical half coupler
BM-M16X040-IB-CS bolt

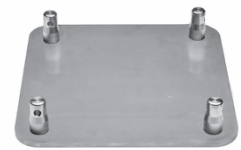
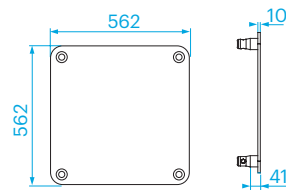

BASE 52V weight = 2,700 kg

Baseplate for 52V truss incl:
CCS7-702/16 Conical half coupler
BM-M16X040-IB-CS bolt



TOOL - HAM - 500 / TOOL - HAM - 750

Copper hammer