

Wire Joint

A Non-stripped Wire Connector

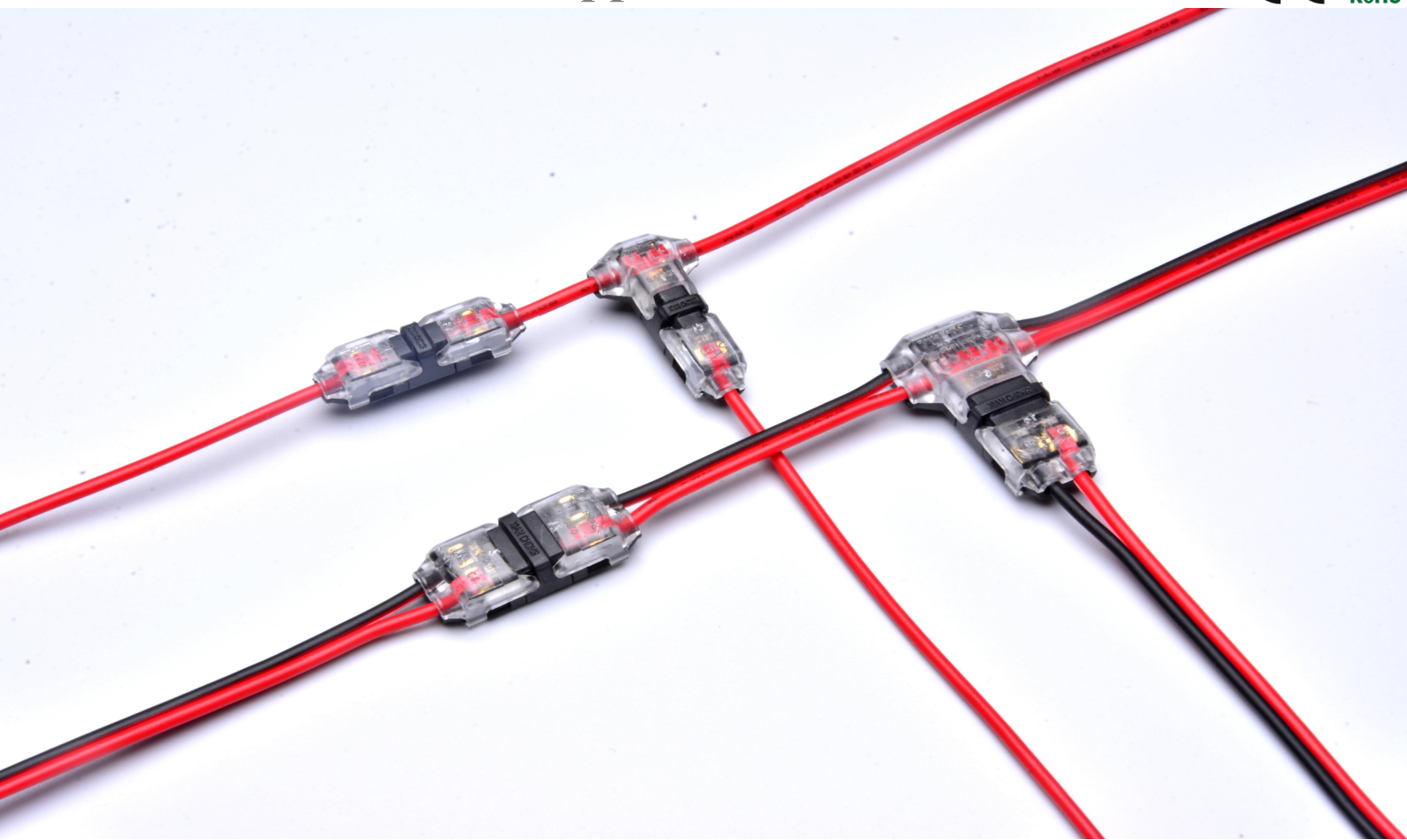

Introduction :

Non-stripped wire connectors, also called as non-peeled wire joint, provide a new concept of wire splicing. Adopting insulation-piercing contact Technology, it allows user to quickly connect wires without stripping insulation, twisting conductor nor tapping around. With this cool connector, wire connection become much more easier, time and cost effective. The whole action of work are just inserting and pressing done by a pliers only !

Features :

- 1.No need to strip the wire before connection.
- 2.No need twisting nor tapping the conductor of wire.
- 3.Easy to use & time saving.
- 4.Flame Retardant.
- 5.Dust-proof.

Item NO. Available



Data :

Item NO.	OL11-WJ-T-2	OL11-WJ-I-2	OL11-WJ-T-1	OL11-WJ-I-1
Production NO.	XC-JXD-T2	XC-JXD-H2	XC-JXD-T1	XC-JXD-D1
Color (Cap/Base)	Transparent & Red / Black			
QTY of Wire Way	2	2	1	1
Polarity NO.	2	2	1	1
Ingress Protection	IP40	IP40	IP40	IP40
Height (closed)	6.7mm	6.7mm	6.6mm	6.6mm
Length	28.6mm	25mm	25mm	25mm
Width	16.8mm (Widest part)	10.4mm	12.8mm (Widest part)	6.8mm
Distance of wire	1.3mm	1.3mm	/	/
Rated Standard	IEC/EN 60664-1			
Over voltage Category EN I	III			
Class of Pollution	2			
Reusable times	≧ 3 times			
Rated Voltage EN	300 V			
Peak Voltage Supportable	2,5 kV			
Max Current (Conductor) EN	10A			
Rated Current (Conductor) EN	≧ 9A			
Workable Conductor Diameter	0,6 - 1,2 mm			
Wire Type Supportable	Solid / Strand			
Workable Wire Gauge	22-18 AWG	22-20 AWG	22-18 AWG	22-20 AWG
Workable Sectional Area	0.75mm ² ~ 0.32mm ²	0.50mm ² ~ 0.32mm ²	0.75mm ² ~ 0.32mm ²	0.50mm ² ~ 0.32mm ²
MAX Workable OD of cable.	2.1 mm			
Housing Material	Polycarbonate			
Contact Metal	High-precision phosphor copper (Cu)			
Normal Working TEMP.	-35~+80℃			
Environment Temperature	-35~+60℃			
Flame Retardant (UL 94)	V-1			
Treatment of Metal	Surface Cleaning			
Standard Packing	Bag.Box/100pcs			

Remark :

1. Rated Current means the metal conductor inside connector can stand, the actual working current in an electrical system is related with wire connected. (gauge, conductor material,etc)
2. When reuse same connector , gauge of the wire to connect better NOT smaller than last wire connected, otherwise it may lead to pool contact.

3.Workable Cable as below

G Direction: 0.75mm² ~ 0.32mm² OD<Φ2.1mm;

D Direction: 0.50mm² ~ 0.32mm² OD<Φ1.8mm;

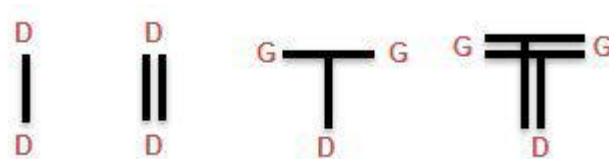

Dimensional Drawing (unit:mm)

OL11-WJ-T-1

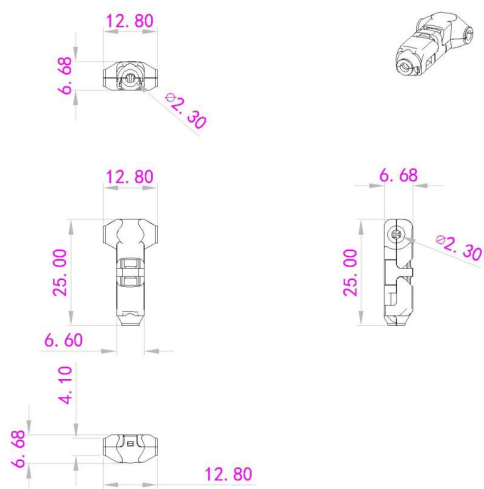

OL11-WJ-T-2

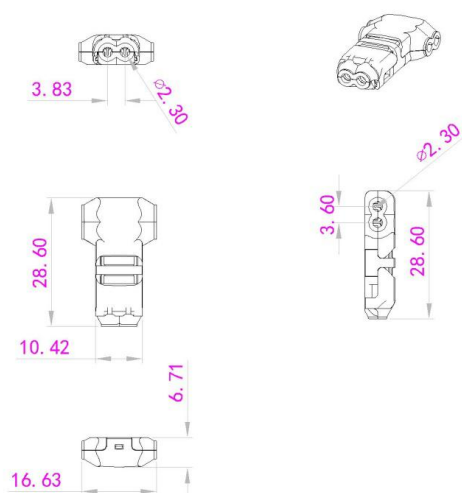

OL11-WJ-I-1

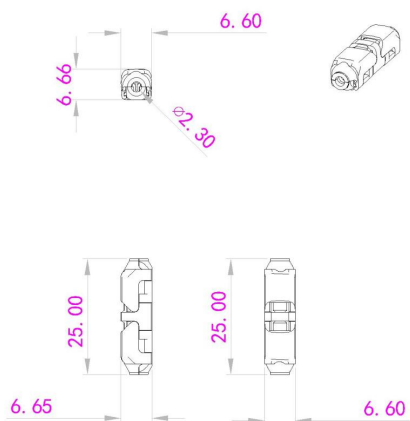

OL11-WJ-I-2

