



## ArtGate Pro

Bidirectional DMX<->ArtNet/sACN converter, splitter, booster, intelligent merger

ArtGate Pro merges up to 4 incoming ArtNet streams as well as any combination of ArtNet, sACN, or DMX streams to outputs for perfect show backup. Configuration is performed through web-interface or ArtGate Settings utility. Supplied in 4-port and 8-port modifications.



### Advantages

- 4 or 8 DMX512 ports (incl. 2 paired M+F)
- 2 Ethernet ports (EtherCON) with switch functionality
- PoE support
- Maximum surge protection – power supply optimized for voltage from 90 to 315 V
- Simple user-friendly web interface
- Configurable DMX port direction and parameters
- Smart DMX output feature
- Supported network protocols: ArtNet I,II,III,4, sACN draft/release, KiNet v1,v2, RTTrPL
- Full RDM E1.20 support (controller/responder)
- Ability to work as standalone splitter/merger
- Fastest recovery after short power failure
- PowerCON TRUE1 inlet+outlet combination
- Trigger inputs for external events and alarms
- DHCP support
- IP address conflict detection

- DMX Bi-Direct**: DMX Bi-Direct
- Double IP**: 2 IP addresses per Device
- User-Friendly Web-Interface**: User-Friendly Web-Interface
- DMX Bi-Direct**: DMX Bi-Direct
- PoE 802.15f**: Power over Ethernet
- ULTRA START**: UltraStart
- Galvanic Isolated Ports**: Galvanic Isolated Ports
- Natural Heat Convection**: Natural Heat Convection
- Trigger Input**: Trigger Input

### Merging Options

- HTP: highest takes precedence
- LTP: latest takes precedence
- AUTO: last modified takes precedence - intelligent merging mode
- BACKUP: primary/secondary universe backup
- PRIORITY: for sACN streams with priority tag
- TRIGGER and X-FADE: dedicated channel / dedicated universe controllable merging

### Application

- Advanced DMX backup
- Transmit more DMX streams with less cables
- Lighting control and management through single Ethernet network
- Convert mapped video content from mapping software into DMX streams
- Ensure interfacing between modern stage lighting software and DMX lighting
- Real-time control of video projectors and laser units supporting ArtNet or sACN from DMX console

# ArtGate Pro

Bidirectional DMX<->ArtNet/sACN converter,  
splitter, booster, intelligent merger

Version: 4.02  
28.04.2020

## Technical Specifications

### Mechanical

**Housing:** solid case  
**Material:** metal  
**Dimensions, mm:** 482(D) x 44(H) x 110(W)  
**Mass:** 1.2 kg  
**Mounting:** rack 1 unit

### Power & Electrical

**Power supply:** ~90-277 VAC, 50/60 Hz,  
PoE 802.15f mode A, B  
**Input Power (max):** 5 W

### Environmental

**Operating Temperature:** 0...+60°C  
**Storage Temperature:** -50...+70°C  
**Operating Relative Humidity (max):** 95%  
**IP Rating:** IP 20  
**Certification:** CE, RoHS  
**Warranty:** 36 month (Return to base)

### Control / Data Connections

**Supported protocols:** DMX512, RDM,  
ArtNet I, II, III, IV, sACN draft, release,  
KiNet v1, v2, RTTrPL  
**DMX refresh rate:** 44 Hz

### Inputs / Outputs

**DMX ports:** 4 or 8 DMX512 ports  
**Connectors:** 2x male XLRs + 4x or 8x female XLRs  
(3- or 5-pin), 2 RJ45/EtherCon, terminal block

### Configuration / Indication

**Setup:** web interface, ArtGate setup utility  
**Indication:** LEDs for DMX and Ethernet activity

### Package Contents

ArtGate Pro  
Power cable

## Product Line

Name	Modification	Product code
ArtGate PRO	4 or 8 DMX inputs / outputs (5-pin) , 2 Ethernet ports	AGP-5-8D2E
	4 or 8 DMX inputs / outputs (5-pin) , 2 Ethernet ports	AGP-5-4D2E
	4 or 8 DMX inputs / outputs (3-pin) , 2 Ethernet ports	AGP-3-8D2E
	4 or 8 DMX inputs / outputs (3-pin) , 2 Ethernet ports	AGP-3-4D2E

# ArtGate Pro

Bidirectional DMX<->ArtNet/sACN converter,  
splitter, booster, intelligent merger

Version: 4.02  
28.04.2020

## Connection Scheme

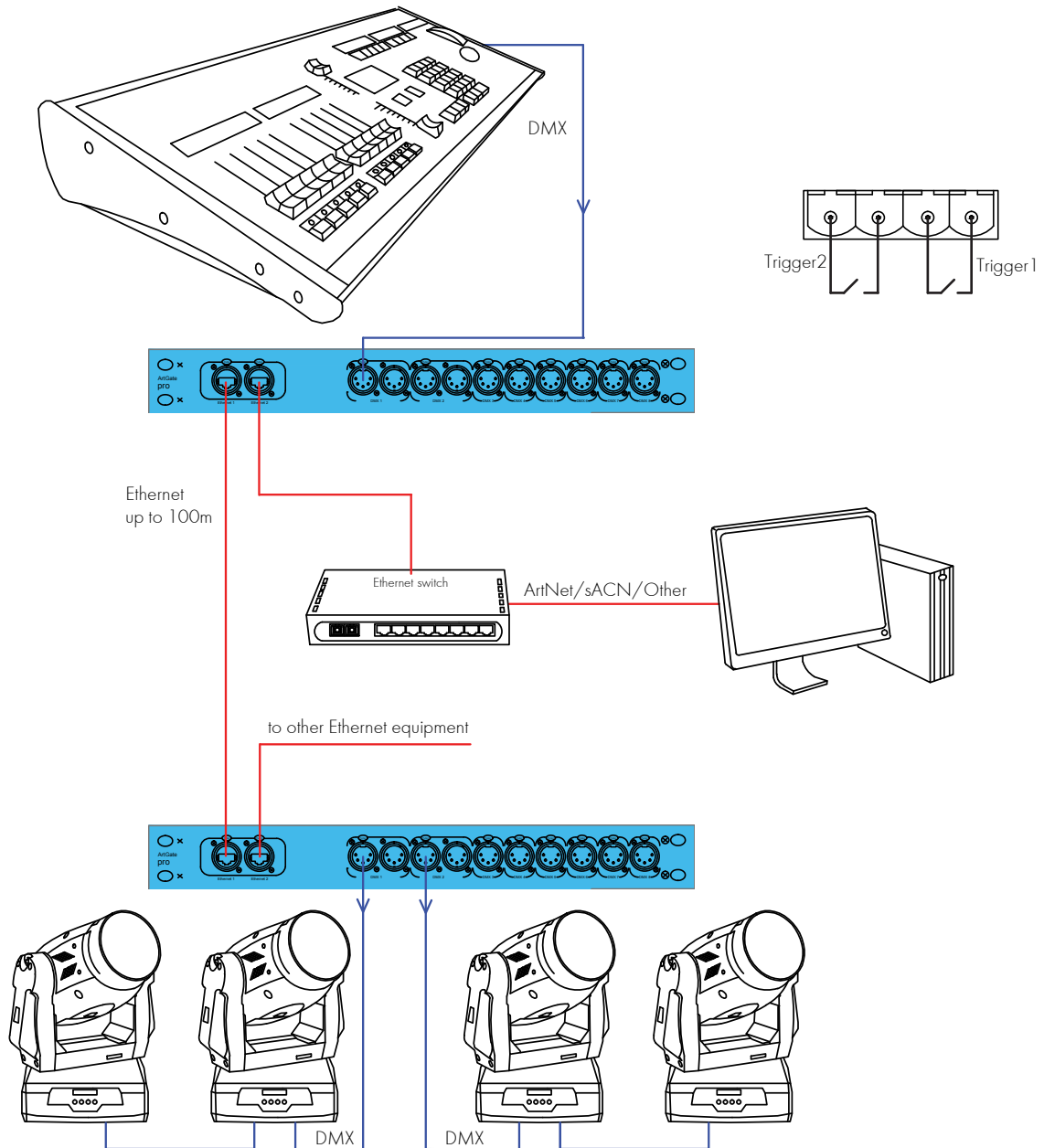

## Accessories

### Name

Truss mounting kit (PRO)

### Product code

DMX-MCA-1-TMK