



ArtGate Pro

Bidirectional DMX<->ArtNet/sACN converter, splitter, booster, intelligent merger

ArtGate Pro merges up to 4 incoming ArtNet streams as well as any combination of ArtNet, sACN, or DMX streams to outputs for perfect show backup. Configuration is performed through web-interface or ArtGate Settings utility. Supplied in 4-port and 8-port modifications.



Advantages

- 4 or 8 DMX512 ports (incl. 2 paired M+F)
- 2 Ethernet ports (EtherCON) with switch functionality
- PoE support
- Maximum surge protection – power supply optimized for voltage from 90 to 315 V
- Simple user-friendly web interface
- Configurable DMX port direction and parameters
- Smart DMX output feature
- Supported network protocols: ArtNet I,II,III,4, sACN draft/release, KiNet v1,v2, RTTrPL
- Full RDM E1.20 support (controller/responder)
- Ability to work as standalone splitter/merger
- Fastest recovery after short power failure
- PowerCON TRUE1 inlet+outlet combination
- Trigger inputs for external events and alarms
- DHCP support
- IP address conflict detection

Merging Options

- HTP: highest takes precedence
- LTP: latest takes precedence
- AUTO: last modified takes precedence - intelligent merging mode
- BACKUP: primary/secondary universe backup
- PRIORITY: for sACN streams with priority tag
- TRIGGER and X-FADE: dedicated channel / dedicated universe controllable merging

- DMX Bi-Direct**: DMX Bi-Direct
- Double IP**: 2 IP addresses per Device
- User-Friendly Web-Interface**: User-Friendly Web-Interface
- DMX Bi-Direct**: DMX Bi-Direct
- PoE 802.15f**: Power over Ethernet
- ULTRA START**: UltraStart
- Galvanic Isolated Ports**: Galvanic Isolated Ports
- Natural Heat Convection**: Natural Heat Convection
- Trigger Input**: Trigger Input

Application

- Advanced DMX backup
- Transmit more DMX streams with less cables
- Lighting control and management through single Ethernet network
- Convert mapped video content from mapping software into DMX streams
- Ensure interfacing between modern stage lighting software and DMX lighting
- Real-time control of video projectors and laser units supporting ArtNet or sACN from DMX console

ArtGate Pro

Bidirectional DMX<->ArtNet/sACN converter,
splitter, booster, intelligent merger

Version: 4.02
28.04.2020

Technical Specifications

Mechanical

Housing: solid case
Material: metal
Dimensions, mm: 482(D) x 44(H) x 110(W)
Mass: 1.2 kg
Mounting: rack 1 unit

Power & Electrical

Power supply: ~90-277 VAC, 50/60 Hz,
PoE 802.15f mode A, B
Input Power (max): 5 W

Environmental

Operating Temperature: 0...+60°C
Storage Temperature: -50...+70°C
Operating Relative Humidity (max): 95%
IP Rating: IP 20
Certification: CE, RoHS
Warranty: 36 month (Return to base)

Control / Data Connections

Supported protocols: DMX512, RDM,
ArtNet I, II, III, IV, sACN draft, release,
KiNet v1, v2, RTTrPL
DMX refresh rate: 44 Hz

Inputs / Outputs

DMX ports: 4 or 8 DMX512 ports
Connectors: 2x male XLRs + 4x or 8x female XLRs
(3- or 5-pin), 2 RJ45/EtherCon, terminal block

Configuration / Indication

Setup: web interface, ArtGate setup utility
Indication: LEDs for DMX and Ethernet activity

Package Contents

ArtGate Pro
Power cable

Product Line

Name	Modification	Product code
ArtGate PRO	4 or 8 DMX inputs / outputs (5-pin) , 2 Ethernet ports	AGP-5-8D2E
	4 or 8 DMX inputs / outputs (5-pin) , 2 Ethernet ports	AGP-5-4D2E
	4 or 8 DMX inputs / outputs (3-pin) , 2 Ethernet ports	AGP-3-8D2E
	4 or 8 DMX inputs / outputs (3-pin) , 2 Ethernet ports	AGP-3-4D2E

ArtGate Pro

Bidirectional DMX<->ArtNet/sACN converter,
splitter, booster, intelligent merger

Version: 4.02
28.04.2020

Connection Scheme

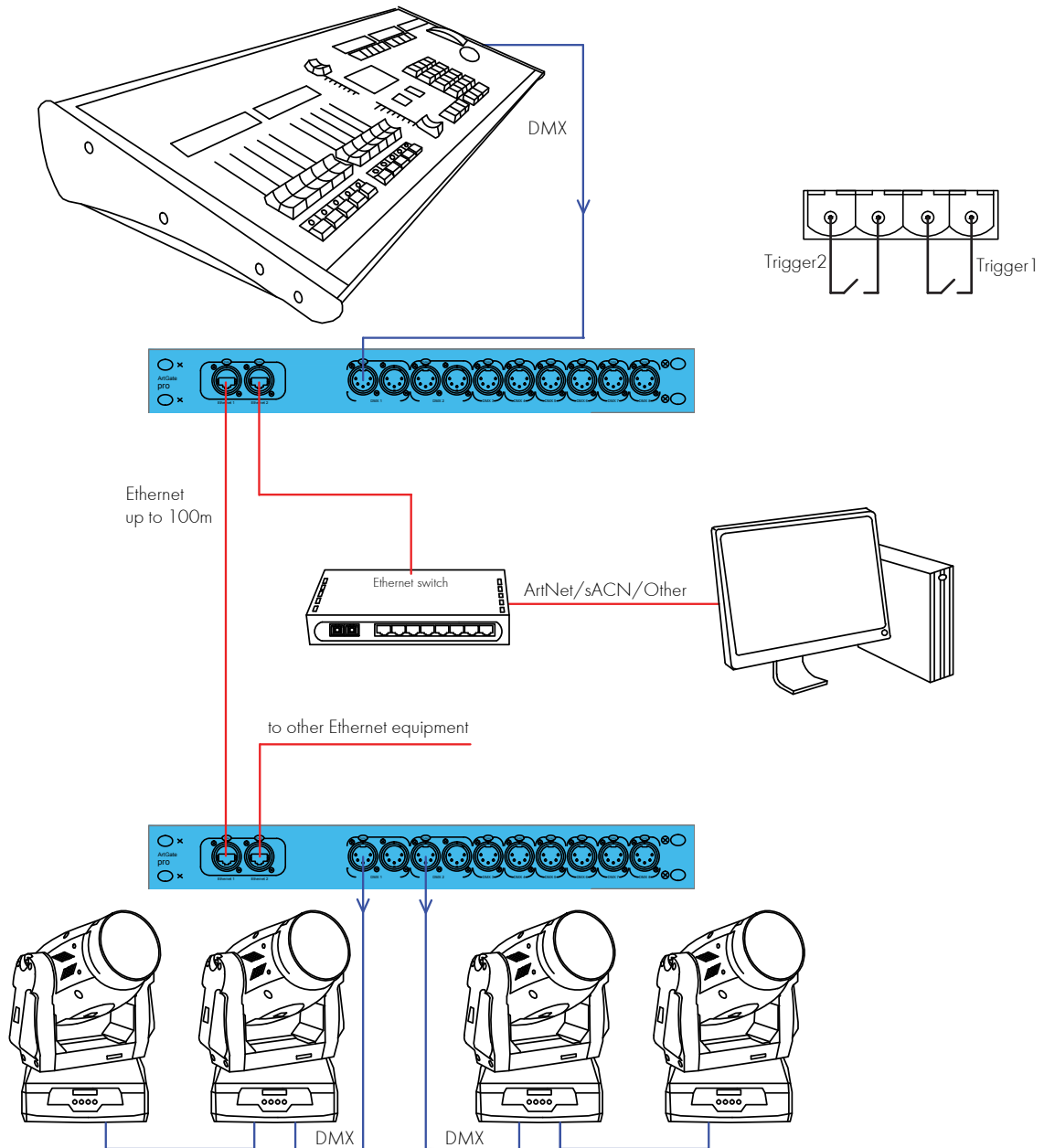

Accessories

Name

Truss mounting kit (PRO)

Product code

DMX-MCA-1-TMK