



ArtGate Solid

ArtGate Solid is an intelligent Ethernet / DMX protocol converter with functions of merging (merging), data backup and is an effective solution for controlling lighting equipment based on the DMX512 interface. A feature of the converter is its versatility, which is expressed in the possibility of various conversions, mergers (merging), DMX512, RDM (ANSI E1.20), ArtNet (1,2,3,4), sACN (Draft, Release), KiNet (v1, v2), RTrPL, data transmission of these protocols via Ethernet, with redundancy functions, as well as the ability to build different combinations of signal transmission / reception. The device can be powered simultaneously (for redundant power supply) or separately, either from a regular 100/240 V network, or using the IEEE 802.3af (Power over Ethernet (PoE)) standard. To connect additional equipment via Ethernet, the converter has a built-in two-port 10/100 Mbit / s switch. To configure the equipment, you can use the built-in Web-interface, the ArtGate Setting utility, third-party software that supports the ArtNet protocol, or the unique specially designed ARISTO software. The device is designed in a vandal-resistant duralumin casing and can be used at positive temperatures indoors and outdoors. The flexibility in placement of the device is characterized by its compactness, small size, the ability to mount on a truss and a horizontal / vertical surface.



Benefits

- Aluminum housing with non-erasable laser engraving
- Tamper-resistant metal housing with IP44 protection
- Maintaining performance at voltages up to 305 V
- Two Ethernet ports
- Supports DMX512, ArtNet (1,2,3,4), RDM (ANSI E1.20), sACN (Draft, Release), KiNet (v1, v2), RTrPL protocols
- "Save" function for setting profiles
- Fixed IP address to access settings
- Intuitive web interface
- Galvanic isolation of DMX ports
- Various merging modes which include: HTP, LTP, AUTO, PRIORITY
- Free cooling function without fans and openings in the case
- PowerCON standard power connector

Application area

- For use in various halls and venues where more DMX streams are required over Ethernet
- For control and flexible control of lighting via a single Ethernet network
- To ensure the conversion of media server video content into DMX streams using equipment of the DMX512 standard
- To provide interoperability between a variety of modern software and a variety of DMX fixtures
- For real-time control of ArtNet or sACN compatible video projectors and laser devices from a DMX console
- To ensure operation with CAST BlackTrax equipment via RTrPL protocol

Technical specifications

Mechanical

Enclosure: solid case
Material: metal, plastic
Dimensions, mm: 171 (L) x 55 (H) x 121 (W)
Weight: 1.2 kg
Installation: surface, truss

Power & Electrical

Power supply: ~ 100-240 V, 50/60 Hz, PoE
Max power consumption: 5W
Fuse: 0.5 A

Environmental

Operating temperatures: -40 ... + 60 ° C
Storage temperatures: -50 ... + 70 ° C
Max. relative humidity: 95%
IP Rating: IP 44
Certificates: EAC, CE, RoHS
Warranty: 36 months

Control / Data Connections

Supported protocols: ArtNet (1,2,3,4) SACN
(draft, release), KiNet (v1, v2), RTrPL
Refresh rate DMX data: 44 Hz

Inputs / Outputs

DMX ports: 2 or 4
DMX connectors: 2 or 4 XLR(3/5/etherCON)M,
2 or 4 XLR(3/5/etherCON)F
Ethernet port: 2 (10/100 Base-TX), PoE
Ethernet connectors: RJ-45/etherCon

Configuration / Indication

Configuration: web interface, ArtGate settings
Indicators: LED, for DMX and Ethernet

Package Contents

ArtGate Solid
Connector set

Product Line

Modification

ArtGate Solid, 2 DMX (3-pin)
ArtGate Solid, 2 DMX (5-pin)
ArtGate Solid, 4 DMX (3-pin)
ArtGate Solid, 4 DMX (5-pin)

Vendor Code

AGS-3-2D2E
AGS-5-2D2E
AGS-3-4D2E
AGS-5-4D2E

Connection diagram

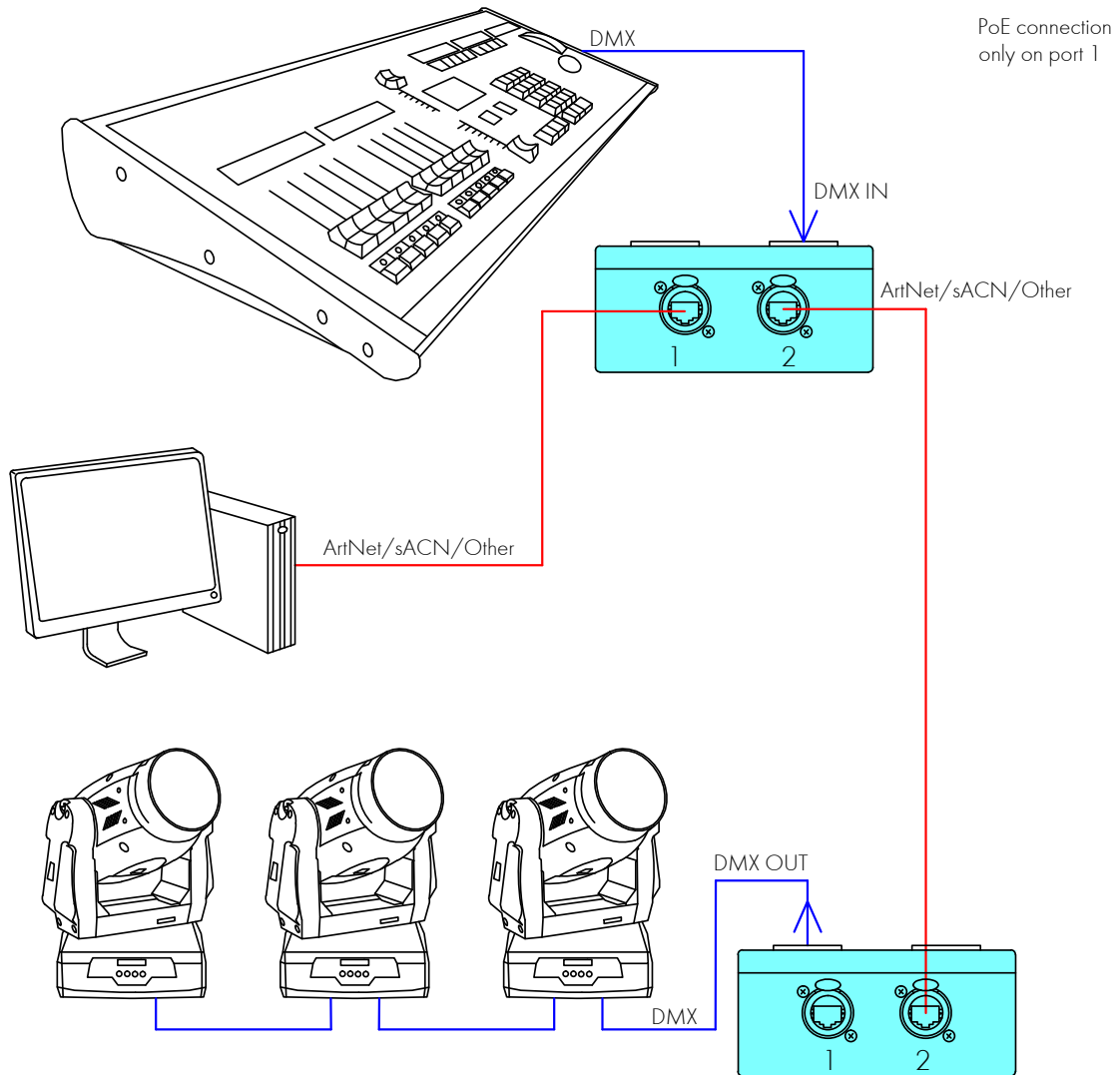

Specifications and appearance of Sandrax Electronics brand equipment are subject to change without notice.

Accessories

Name

- Ethernet cable etherCON, 1.5m
- Cable DMX (5-pin)M/(5-pin)F, 3m
- Cable DMX (5-pin)M/(5-pin)F, 0.5m
- Adapter (5-pin)F/(3-pin)M
- Adapter (5-pin)M/(3-pin)F
- Solid / Arma Series Large Enclosure Mount Kit
- Clamping Kit for Large Solid / Arma Series Enclosures

Vendor Code

- ACC-CCE-X/EC15
- ACC-CCDMX-5F/5M3
- ACC-CCDMX-5F/5M05
- ACC-AD-N5F/N3M
- ACC-AD-N5M/N3F
- ACC-MK-B(SO/AR)-SUR
- ACC-MK-B(SO/AR)-CLA