



IsoGate Board

IsoGate Board is amplifier and repeater of signals of the DMX512 interface.

A feature of the repeater is the function of amplification, repetition DMX512 protocol signals for increased range and load capacity of DMX lines, as well as function galvanic isolation of DMX ports in order to protect it from ingress high voltage control lines of various equipment using the DMX512 protocol for control.

The device can be supplied with constant power depending on the setting: voltage 5V or 9-36V. Flexible placement options the device is characterized by its small size, allowing install the device in various "hatches", niches or housings third-party equipment.

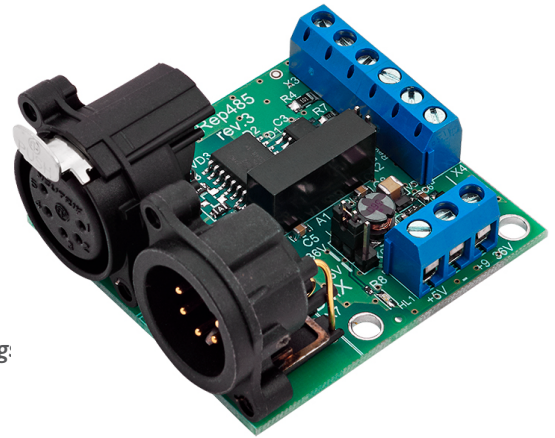

Benefits

- Frameless execution
- Supports DMX512, RDM (ANSI E1.20) protocols
- Galvanic isolation of DMX ports
- Different ranges of supply elements (5V or 9-36V)
- Supports one TRUE DMX loop through port

Application area

- Used for installations where it is necessary to increase length or load capacity of the DMX512 interface
- Used for installation inside lighting fixtures, supporting the DMX512 protocol in order to protect them from hitting the interface with high voltage

Technical specifications

Mechanical

Housing: No

Dimensions, mm: 58 (L) x 27 (H) x 50 (W)

Weight: 0.05 kg

Installation: stage equipment, lamps, etc.

Power & Electrical

Power supply: 5V or 9-36V

Max Power Consumption: 1W

Environmental

Operating temperatures: 0 ... + 60 ° C

Storage temperatures: -50 ... + 70 ° C

Max. relative humidity: 95%

IP Rating: no

Certificates: EAC, CE, RoHS

Warranty: 36 months

Control / Data Connections

Supported protocols: DMX512, RDM

Refresh rate DMX data: 44 Hz

Inputs / Outputs

DMX ports: 2

DMX connectors: 1 XLR (3/5) M, 1 XLR (3/5) F

Galvanic isolation connectors:
terminal blocks DG306-5.0-03P

Configuration / Indication

Setting: 2 jumpers

Indicators: LED for power

Package Contents

IsoGate Board

Product Line

Modification

IsoGate Board, (3-Pin)

IsoGate Board, (5-Pin)

Vendor Code

IGB-3-ID

IGB-5-ID

IsoGate Board

Version: 4.00
20.01.21

Connection diagram

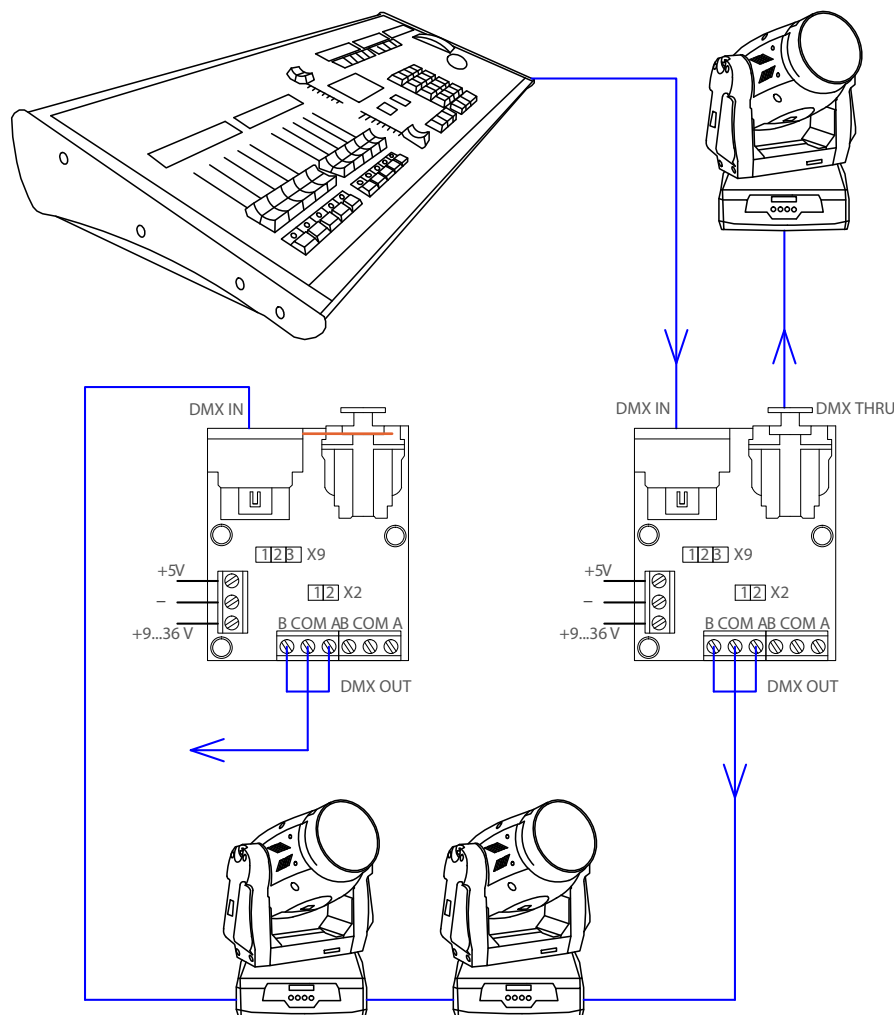

When using a 5V power supply, place a jumper on pins 1 and 2 on X9.
When using a 9-36V power supply, place a jumper on pins 2 and 3 on X9.

To select XLR connectors as input and terminal blocks as output: do not put a jumper on X2.
To select terminal blocks as input and XLR connectors as output: set a jumper to X2.

Specifications and appearance of Sandrax Electronics brand equipment are subject to change without notice.

Accessories

Name

DMX cable (5-pin) M / (5-pin) F, 0.5m
DMX cable (5-pin) M / (5-pin) F, 3m
Adapter (5-pin) F / (3-pin) M
Adapter (5-pin) M / (3-pin) F
Surface mounting kit for Board series

Vendor Code

ACC-CCDMX-5F/5M05
ACC-CCDMX-5F/5M3
ACC-AD-N5F/IN3M
ACC-AD-N5M/IN3F
ACC-MK-BO-SUR