

xVision Converter SDI to Fiber - True1



XVVSDI2FIBERT1

● Fiber — A starting point



Professional equipment in mission-critical applications is all about reliability and confidence. So we started with a clean sheet, and built what might soon become your most trustworthy piece of equipment.

Introducing the world's first video converters truly designed for the road. Video converters nowadays are used everywhere on professional

A/V events, presentations, live shows and tours and often have a critical role. Yet, they are often the weakest link in the signal chain. Low quality connectors, weak enclosure, external consumer-grade power supply, and overall barebones design that all contribute to a generally unreliable piece of equipment. We wanted to change that, so we designed the xVision Video Converters.

Features

- > **Integrated power supply** with locking PowerCON Connector. Never rely on a cluster of wall-warts again.
- > **Built-in convenience AC** outlet to power nearby projector, TV, laptop, small video projector... Power bar to power both the converter and device not required anymore.
- > **Magnetic stacking system** and non-skid rubber pad for tabletop application. Saves at least 10 gaffer tape rolls a year.
- > **Multiple mounting options:** C-Clamp, wall-mount adapter, LCD mount adapter and belt adaptor.
- > **Rugged, Tour-ready and aesthetic enclosure:** The sexiest widget in your tool box, that will keep looking good for years to come.

- > **Plug-n-play operation;** No dipswitches, buttons or menus to fumble with: It just works.
- > Clear and ample status **LED indicators** for quick troubleshooting.
- > **Easy on-the-field identification** with unique color and alphabetic coding system.
- > **SFP-based** video transmission for interoperability with standard SDI over fiber devices.
- > **Choice of three** optical connectors, each available as singlemode and multimode types.
- > **Relocked and amplified** SDI loop thru.
- > Proudly designed and assembled **in Canada**.

Ordering Information

XVVSDI2FIBERT1-111... xVision Converter SDI to FIBER True1

XVVSDI2FIBER-111..... xVision Converter SDI to FIBER

Singlemode: **S** ———— **1**:ST Connector
Multimode: **M** ———— **2**:OpticalCON DUO
 3:OpticalCON QUAD

XVV-CC1 xVision Converter Carrying case for 1 unit

XVV-CC2 xVision Converter Carrying case for 2 units

XVV-CC3 xVision Converter Carrying case for 3 units

XVV-VM-A xVision Converter Vertical Mount

MSCB-CS Mega Slim coupler - black with countersunk

Specifications

Overview

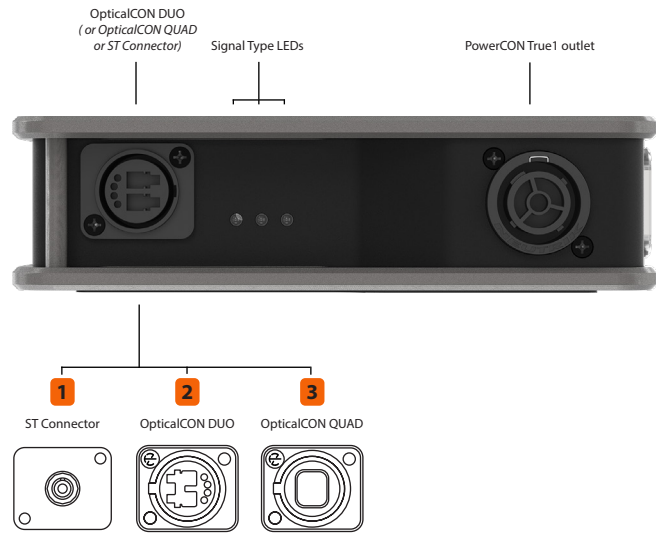
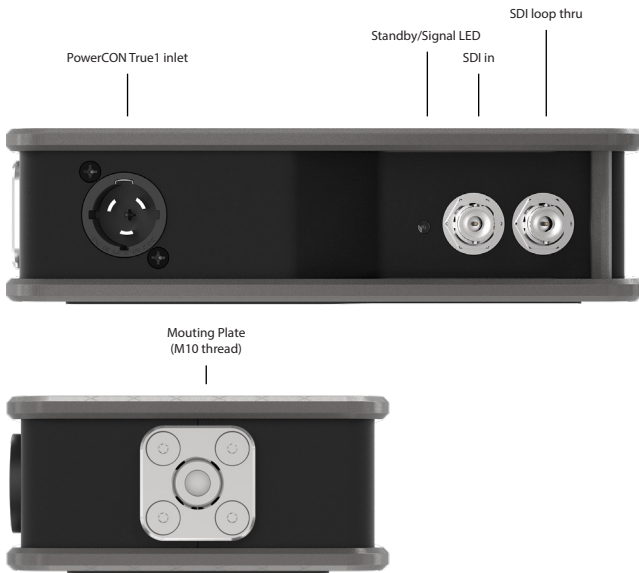

Connections

Video Input	1 x 3G/HD/SD SDI BNC
Loop-thru	1 x 3G/HD/SD SDI BNC
Video Output	Choice of Multimode or Singlemode Choice of Optical SDI on ST, OpticalCON DUO or OpticalCON QUAD (see ordering information)

Supported Signals

Video Format Support	3G-SDI Level A and B, HD-SDI, SD-SDI with embedded audio
SMPTE Standards	425 M Level A & B, 424 M, 292 M, 259 M

Physical Specifications

Height	50 mm (1.97 in)
Depth	180 mm (7.08 in)
Width	107 mm (4.21 in)
Weight	1 kg (2.2 lbs)
Alternate Form Factor	Also available as a Reversible Module

Environmental Specifications

Relative Humidity	0% to 90% non-condensing
Operating Temperature	0-40 °C

Power Requirements

Power Supply	Built-in power supply PowerCON True1 input PowerCON True1 output (loop-thru)
Power Consumption	15W
Voltage Range	100-240V, 50-60Hz (100-120V, 50-60Hz available with PowerCON/ Edison Nema 5-15)
Courtesy Outlet	Max 10A, same voltage as input

In the Box

xVision Converter SDI to Fiber True1
AC Mains PowerCON True1 cable (1.5m, specify plug type at ordering)

Certifications & Compliance

This device complies with the following international standards

